

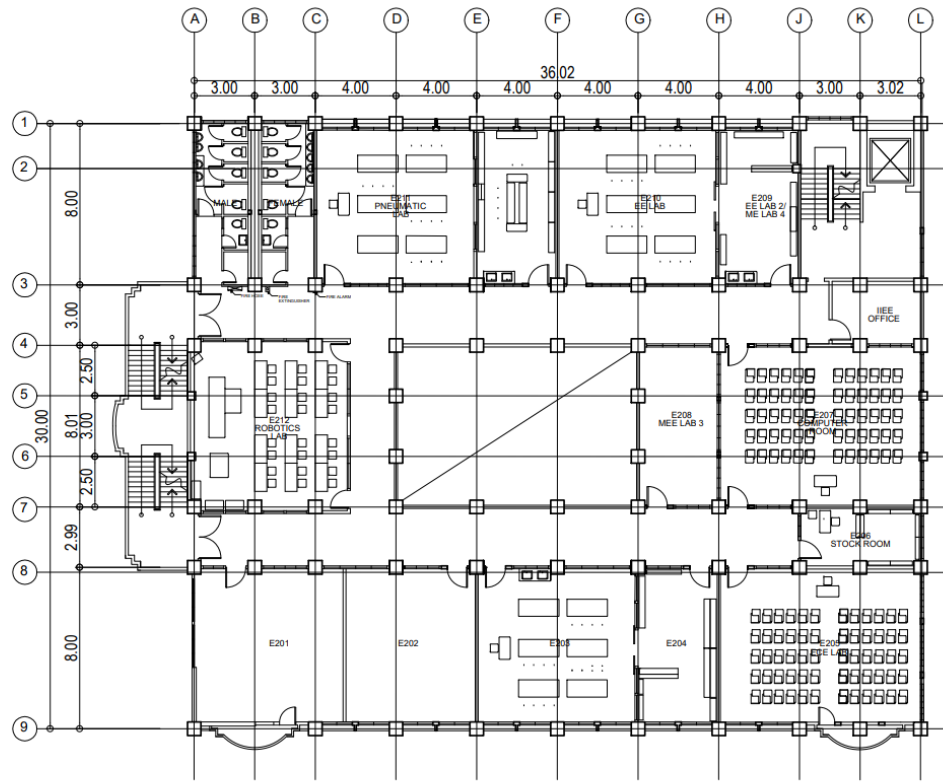

BULACAN STATE UNIVERSITY

NATIVIDAD HALL 2ND FLOOR PLAN



1
A 2
SCALE 1:200 MTS.

PROJECT MANAGEMENT OFFICE BULACAN STATE UNIVERSITY BLDG. GUINAHAWA, CITY OF MALOLOS, BULACAN Tel. No. (044) 791-6200 E-mail Address: bulsu.pmo2013@gmail.com	SUBMITTED BY:	RA 9266 SECTION 33	PROJECT TITLE:	RECOMMENDING APPROVAL:	APPROVAL:	SHEET CONTENTS:	SHEET NO.:
	ARCH. MASATURNINA C. PARUNGAO DIRECTOR, PROJECT MANAGEMENT OFFICE (PMO)	<small>Notwithstanding to specifications and other contract documents duly signed, executed or sealed, no amendments or additions, nor the alteration of property and documents of the architect, whether the object to which they are made is essential or not, shall be admitted for any purpose to duplicate or make copies of said documents for use in the execution of work for other projects or in similar, whether executed partly or wholly, without the written consent of the architect or author of said documents to.</small>	PROPOSED INFIRMARY	DR. DANILO S. HILARIO VP-PLANNING, RESEARCH & EXTENSION	DR. MARIANO C. DE JESUS UNIVERSITY PRESIDENT	GROUND FLOOR	<div style="border: 1px solid black; border-radius: 50%; width: 40px; height: 40px; display: flex; align-items: center; justify-content: center; margin: 0 auto;"> A-2 5 </div>
	PRC: 8811 PTR: 1791337 PLACE: CITY OF MALOLOS	TIN: 148 87 1984 DATE: 01/05/2015	LOCATION: BSU MALOLOS CAMPUS	DES. BY: DRWN BY:			

LABORATORY LAYOUT

E 203 Pneumatics Laboratory - 2nd Floor Natividad Hall

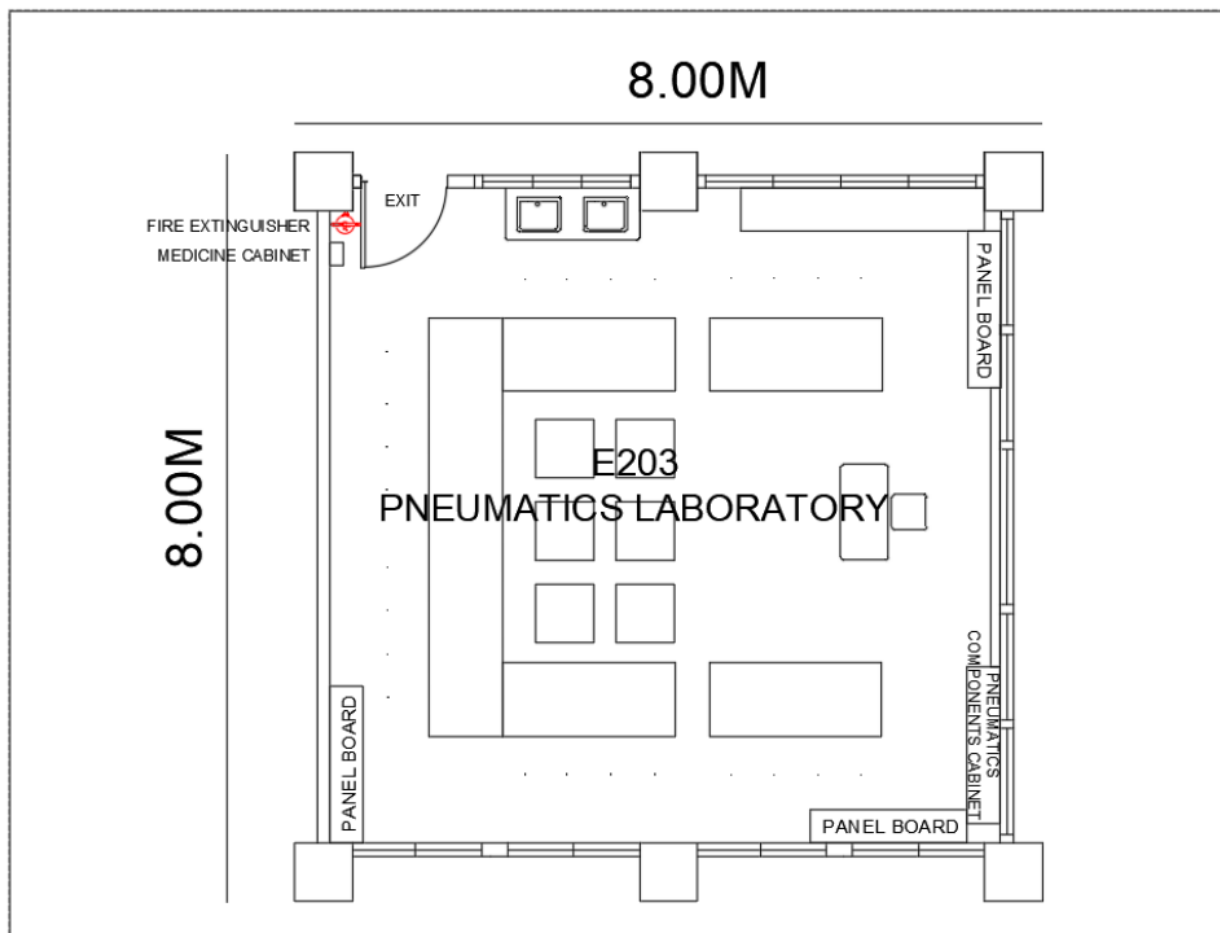

The Mechatronics Engineering Department utilizes NH Room 203 as a Pneumatic Laboratory with a working capacity of 35 Students.

LABORATORY LAYOUT

E 203 Pneumatics Laboratory - 2nd Floor Natividad Hall



LABORATORY LAYOUT

E 208 Mechatronics Laboratory - 2nd Floor Natividad Hall

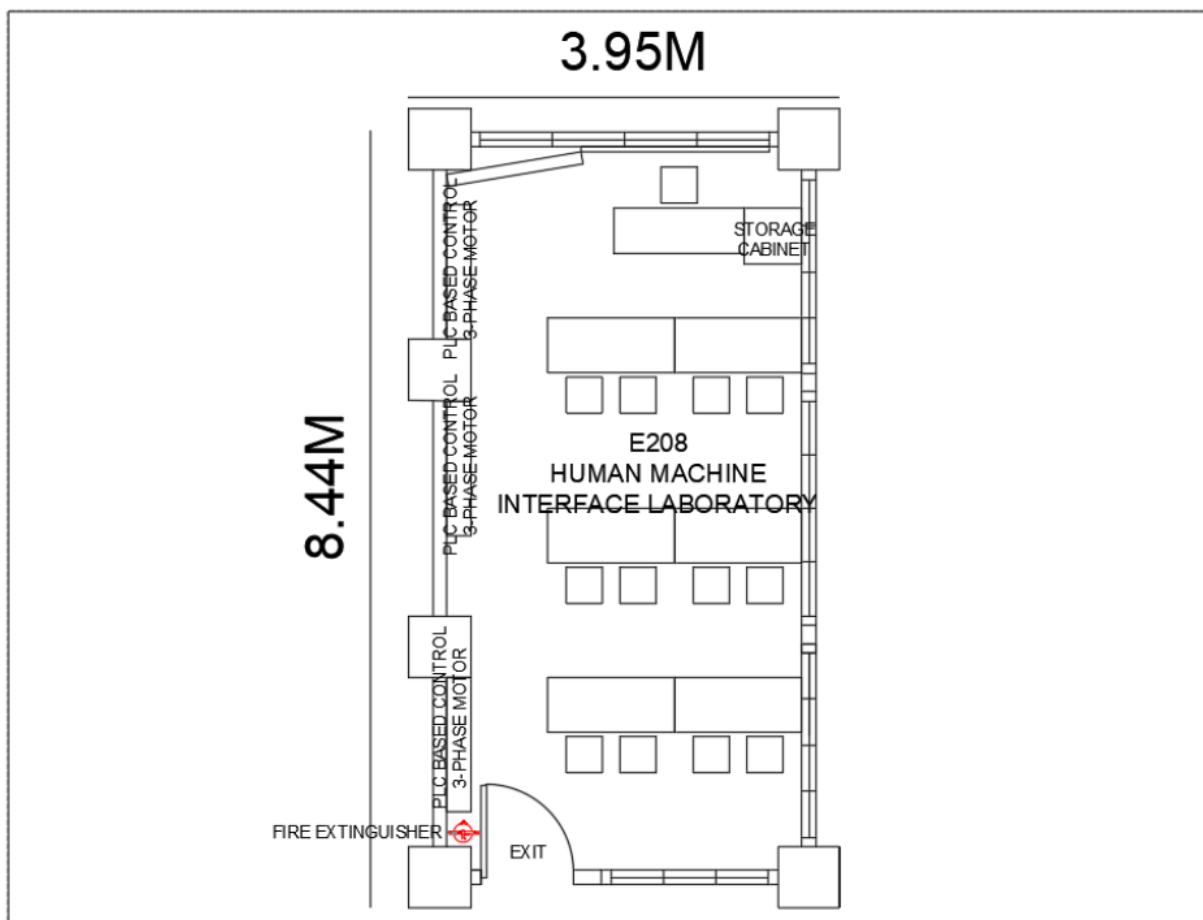

The Mechatronics Engineering Department utilizes NH Room 208 as a Mechatronics Laboratory with a working capacity of 25 Students.

LABORATORY LAYOUT

E 208 Mechatronics Laboratory - 2nd Floor Natividad Hall



LABORATORY LAYOUT

E 212 Robotics Laboratory - 2nd Floor Natividad Hall

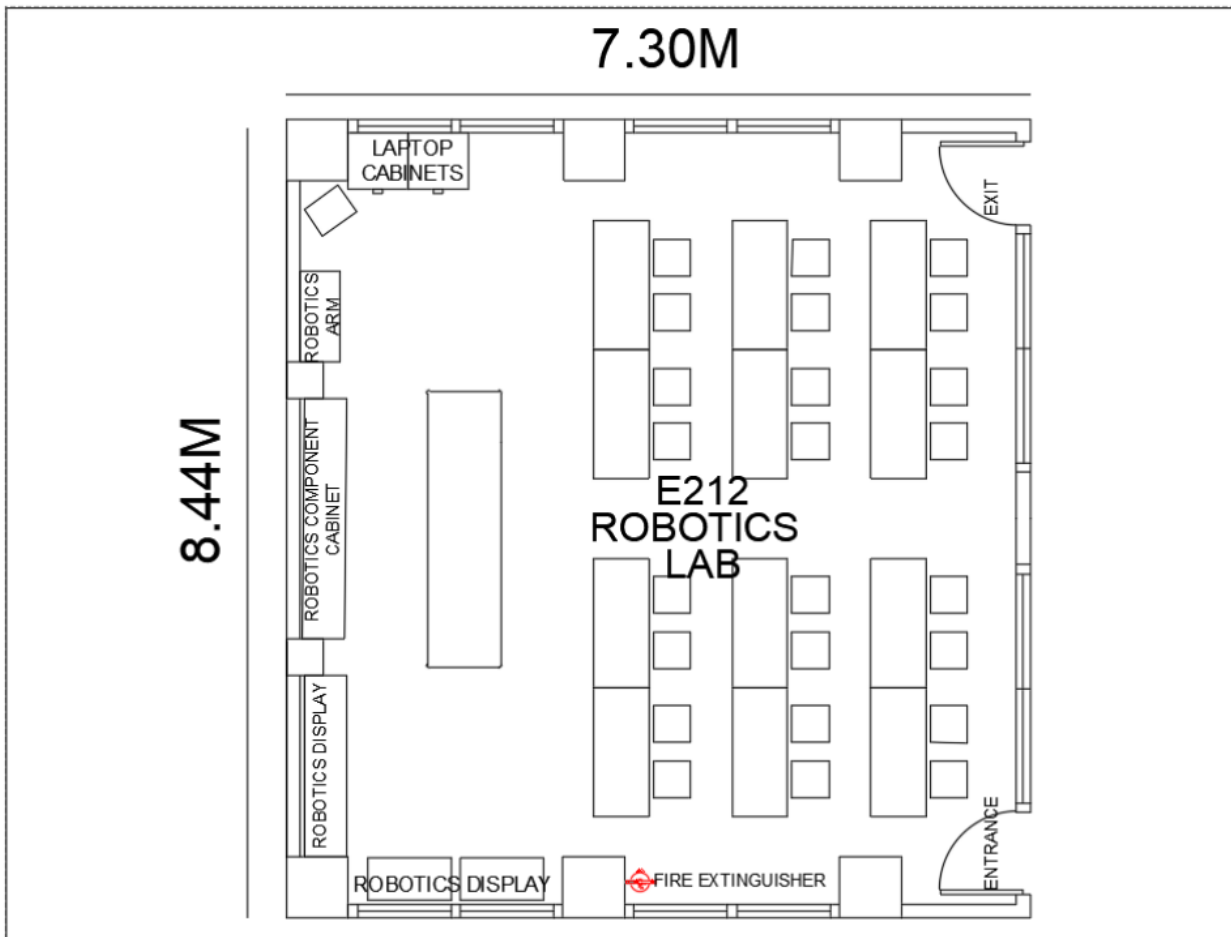

The Mechatronics Engineering Department utilizes NH Room 212 as a Mechatronics Laboratory with a working capacity of 35 Students.

LABORATORY LAYOUT

E 212 Robotics Laboratory - 2nd Floor Natividad Hall

